

MOLDED DOCK BUMPERS

FEATURES:

MOLDED RUBBER DOCK BUMPERS COME WITH COUNTERSUNK HOLES FOR EASY MOUNTING ON POURED CEMENT FOUNDATION.

POPULAR MODELS IN RED

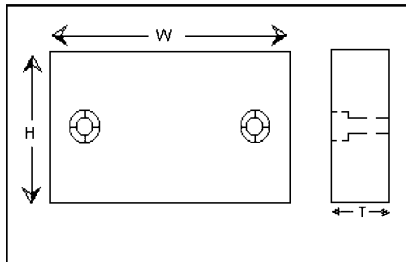

FREIGHT CLASS: 55 OR UPS

MODEL	WIDTH	HEIGHT	THICKNESS	NO. OF BOLTS	WEIGHT (LBS.)	BOLT SIZE	SUGGESTED PRICE
KMB-13124	13"	12"	4"	4	20	3/4" x 6.25"	\$45.00
KMB-18104	18"	10"	4"	2	24	3/4" x 6.25"	\$61.25
KMB-18184	18"	18"	4"	3	27	3/4" x 6.25"	\$62.50
KMB-24104	24"	10"	4"	2	33	3/4" x 6.25"	\$70.00
KMB-30104	30"	10"	4"	3	41	3/4"x6.25"	\$97.50

OPTIONS

PART #	DESCRIPTION	PRICE
AB4	3/4" x 6.25" ANCHOR BOLT	\$5.36